

# BOX MINI

12-Jun-2019

## 1.0

PAR16 max. 15W | GU10 | 100-240VAC | 50-60Hz  
 CE IP20 0.9m

### aluminium

white texture	300120W0
aluminium brushed	300120L0
copper	300120P0
black texture	300120B0

### wood

walnut wood	300120WN0
-------------	-----------

### OPTIONAL

for PAR16 lamps see our catalogue

## 2.0

2xPAR16 max. 15W | GU10 | 100-240VAC | 50-60Hz  
 CE IP20 0.9m

### aluminium

white texture	301120W0
aluminium brushed	301120L0
copper	301120P0
black texture	301120B0

### wood

walnut wood	301120WN0
-------------	-----------

### OPTIONAL

for PAR16 lamps see our catalogue

BOX MINI 1.0

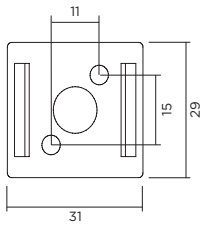

BOX MINI 2.0

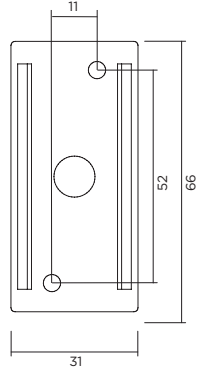

BOX MINI 1.0

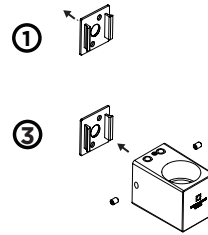

BOX MINI 2.0

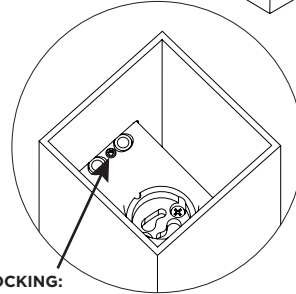
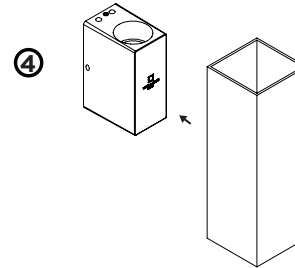
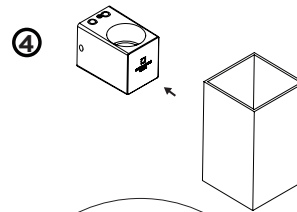
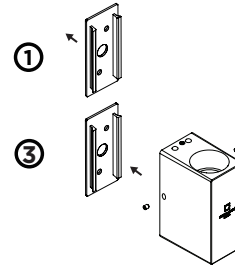

### FOR OPTIONAL LOCKING:

\* Lock the cover by unscrewing the grub screw app. 3mm. Then the cover is stable.

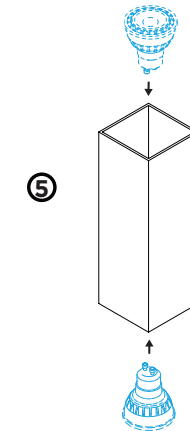
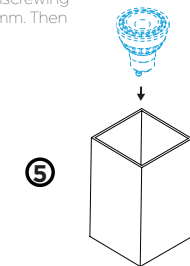

## DIMENSIONS

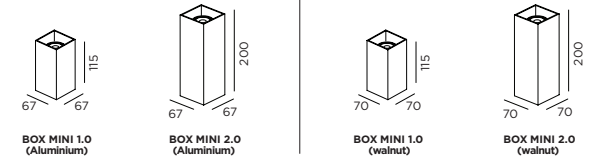

## MOUNTING INSTRUCTION

- 1 Mount the base plate on the wall

## POWER CONNECTION

- 2 Connect the power supply.

Interior: STANDARD version

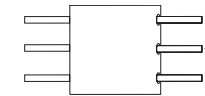

- 3 Mount inset on the back plate with side screws

- 4 Click cover over the inset

\* For optional locking, unscrew the grub screw app. 3mm. The cover is now stable.

- 5 Mount the bulb.



WEVER & DUCRÉ  
LIGHTING

www.weverducre.com

Wever & Ducre bvba Spinnerijstraat 99/21 8500 Kortrijk

INSTALLATION  
INSTRUCTIONS