

# CARD

INSTALLATION INSTRUCTIONS | NOVEMBER 2022

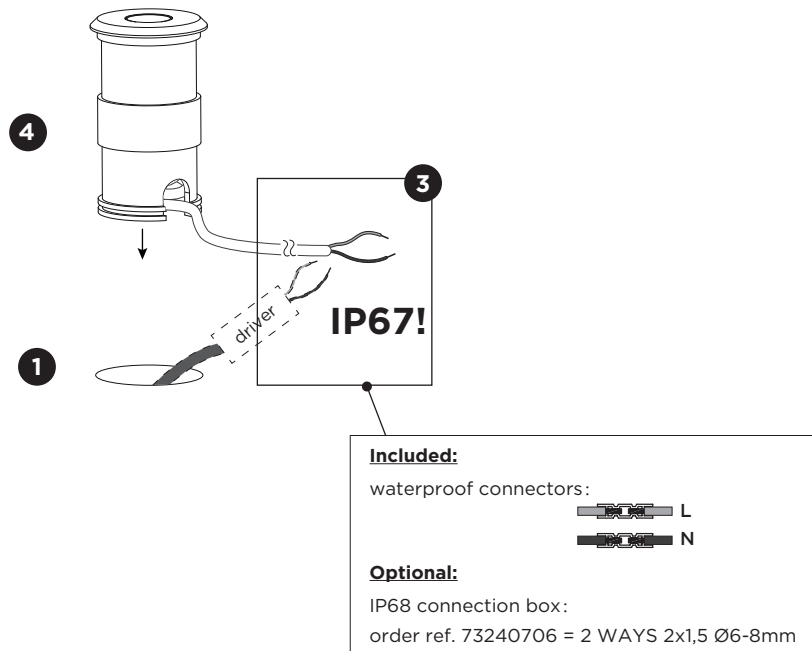

## DIMENSIONS

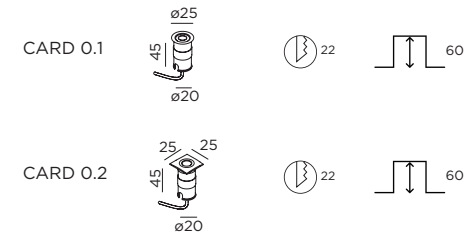

## MOUNTING INSTRUCTION

- 1 Make a hole in the ground according to the prescribed dimensions of the fixture.
- 2 Drainage: we recommend that all exterior groundspots should be installed with a drainage level.

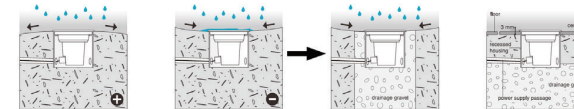

## POWER CONNECTION

Always use a driver according to the specifications of the LED module. Make sure to use a waterproof connection. Please see the detail method in the separate instruction sheet of waterproof connection.

### Single connection

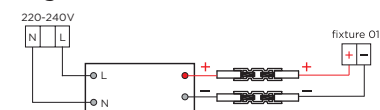

### Multiple connection

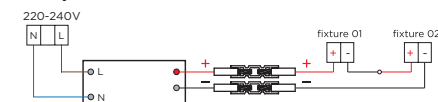

- 4 Insert the fixture in the hole.

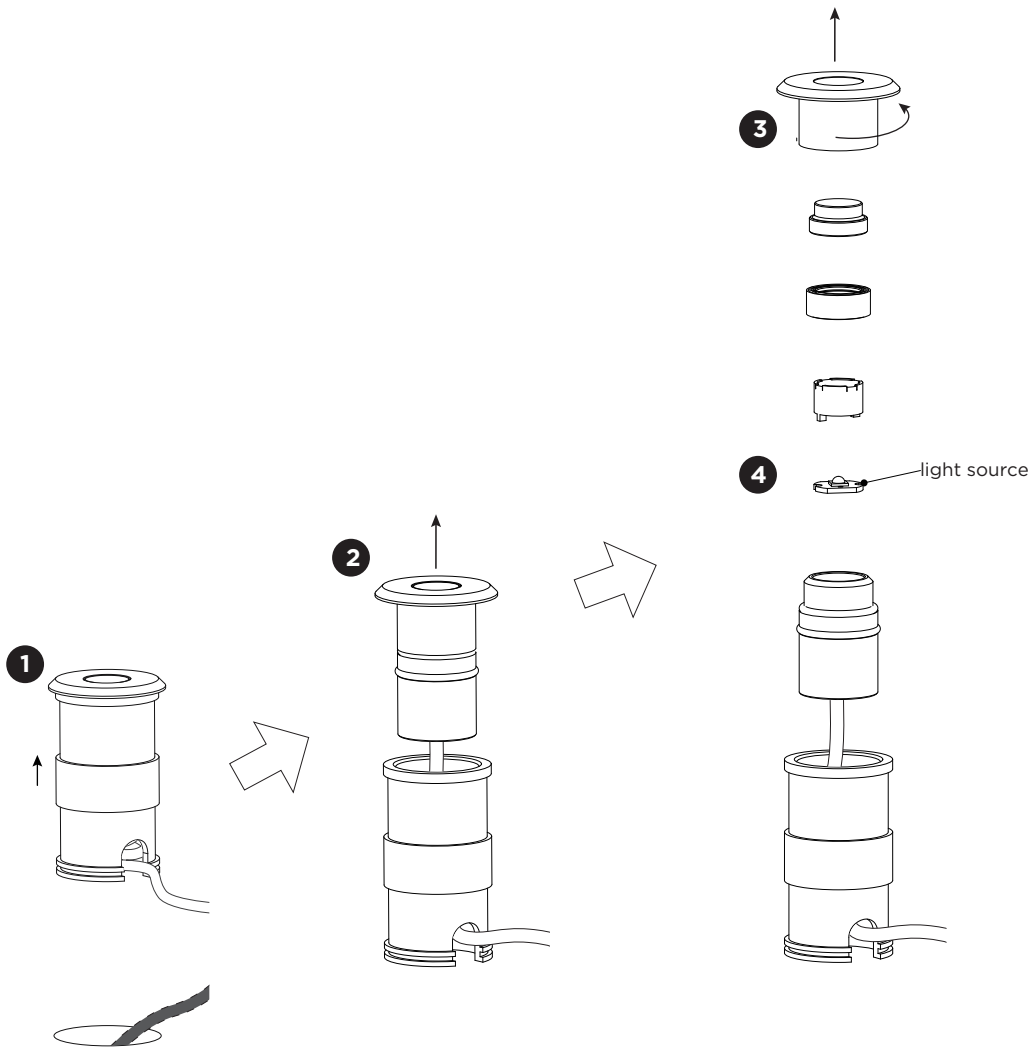

## DISMOUNTING AND RECYCLING INSTRUCTIONS

Light source

- 1 Remove the luminaire from the ground hole.
- 2 Pull out the fixture from it's recessed housing.
- 3 Turn off the cover.
- 4 Dismount all components to remove the light source.

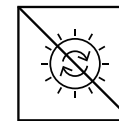

The light source is not replaceable.



This luminaire contains a light source with the energy class F.