

# MAP 1.2/1.6 & MAP ASYM 1.2/1.6

INSTALLATION INSTRUCTIONS | APRIL 2022

with ground housing

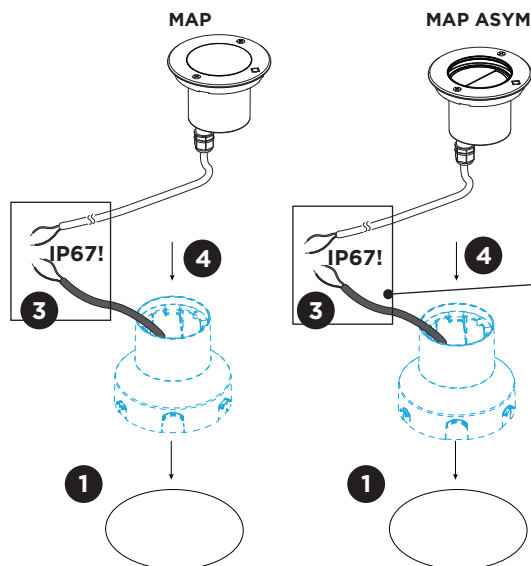

**Included:**  
waterproof connectors:

**Optional:**  
IP68 connection box:  
order ref. 73240706 = 2 WAYS 2x1,5 Ø6-8mm

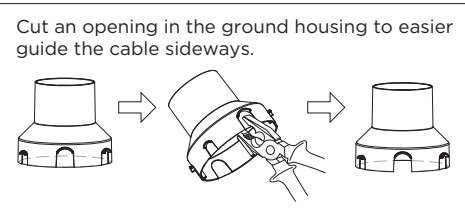

## DIMENSIONS

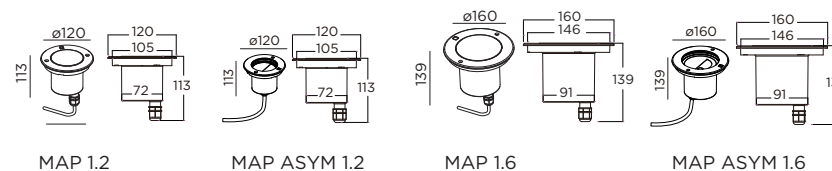

## MOUNTING INSTRUCTION WITH GROUND HOUSING

- 1 Make a hole in the ground according to the prescribed dimensions (of the ground housing).
- 2 Drainage: we recommend that all exterior groundspots should be installed with a drainage level even when using a recessed housing.

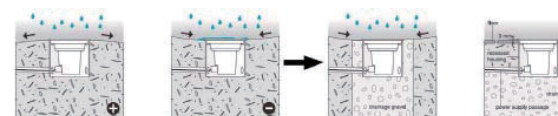

## POWER CONNECTION

- 3 Connect to 220-240V and use waterproof connections.
- 4 Use screws to attach the fixture to the ground housing, screws are included.

optional ground housing

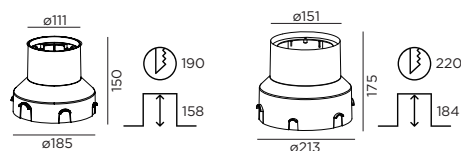

90012203  
for MAP 1.2  
for MAP ASYM 1.2

90012204  
for MAP 1.6  
for MAP ASYM 1.6

# MAP 1.2/1.6 & MAP ASYM 1.2/1.6

INSTALLATION INSTRUCTIONS | APRIL 2022

without ground housing

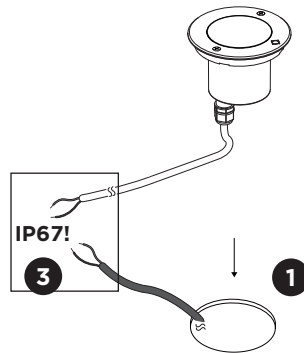

waterproof connection:

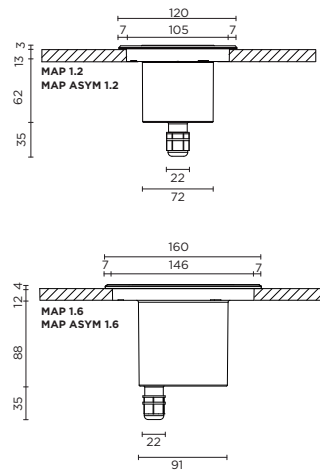
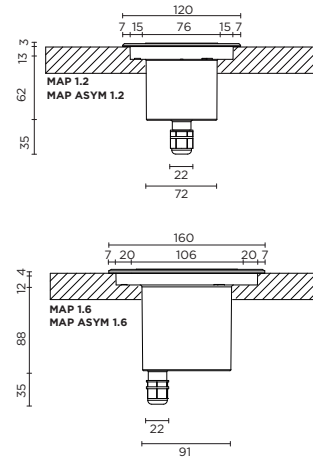
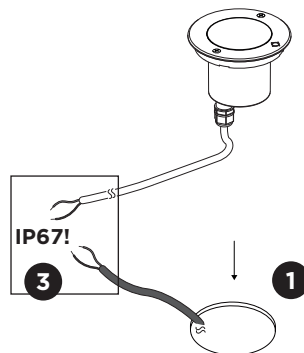

## MOUNTING INSTRUCTION WITHOUT GROUND HOUSING

A. Attached to the floor (or wall, for wall mounting).

- Use the screws (included) to attach the luminaire to the floor or wall. Make sure to measure correctly so that you can screw into a hard material.

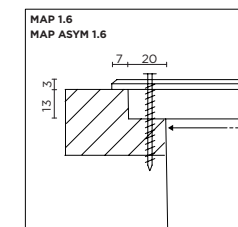
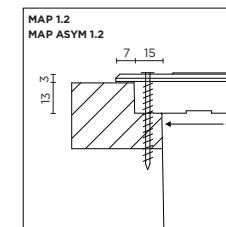

B. Rests on the stainless steel borders of the fixture.

- Place the luminaire into the hole. No tool is needed to fix the luminaire as it will rest on the stainless steel frame.

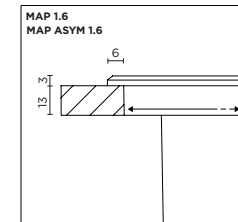
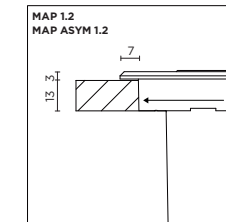

Note:  
the bolts and  
nuts can be used  
for filling the  
screwholes.

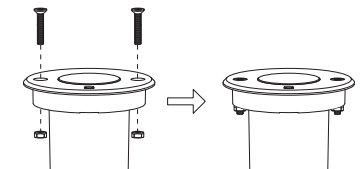

# MAP 1.2/1.6 & MAP ASYM 1.2/1.6

INSTALLATION INSTRUCTIONS | APRIL 2022

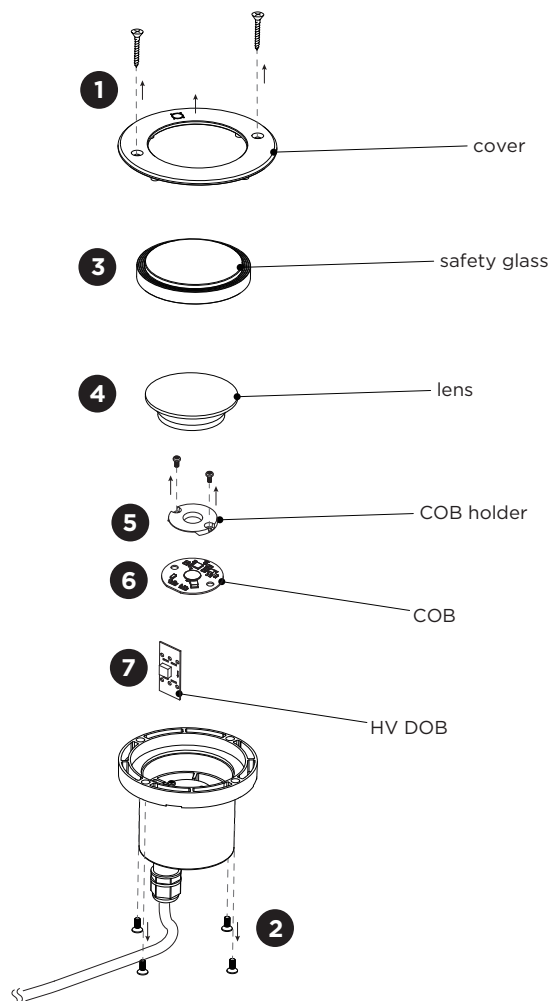

## DISMOUNTING INSTRUCTION

### light source

- 1 Remove the screws and take out the fixture.
- 2 Remove the four screws below and remove the cover.
- 3 Remove the safety glass.
- 4 Remove the lens.
- 5 Remove the screws and the COB holder.
- 6 Disconnect the wires and remove the COB.
- 7 Remove the HV DOB.

To replace the light source please contact your Wever & Ducré customer service contact point.

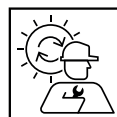

This luminaire contains a light source with the energy class F.

